

Heavy Square Washer

Material: Mild Steel

Class Grade: Low Tensile Class 4.6

Corrosion Protection Level: Moderate

Finish: Zinc Yellow

Standard: HEC Standard

System Of Measurement: Metric

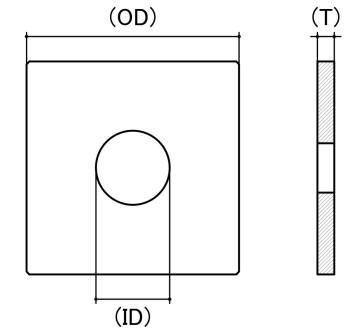

*CAD drawings shown for graphic representation only.**

Industry Size	Inside Dimension (ID) (mm)		Outside Dimension (OD) (mm)	Thickness (T) (mm)		sku (qfind)
	Min	Max	Nom	Min	Max	
M10 x 38 x 38 x 3	10.70	11.70	38.00	2.60	3.00	71HS1038383
M10 x 50 x 50 x 3	10.70	11.70	50.00	2.60	3.00	71HS1050503
M12 x 50 x 50 x 3	13.20	14.20	50.00	2.60	3.00	71HS1250503
M12 x 50 x 50 x 5	13.20	14.20	50.00	4.30	5.00	71HS1250505
M16 x 50 x 50 x 5	17.10	18.40	50.00	4.30	5.00	71HS1650505
M16 x 65 x 65 x 5	17.10	18.40	65.00	4.30	5.00	71HS1665655

Disclaimer:

Dimensional data and technical information was obtained from publically available sources and not acquired through standard agencies. It has been completed and compiled for reference purposes only; where discrepancies are found they are subject to change without notice. Bolt & Nut Australia makes no warranties or representations regarding the accuracy and validity of the compiled information and data. Contact the relevant standard authorities for accurate and detailed information.

* CAD drawings may not reflect diameter, thread length or overall length.

© Bolt & Nut Australia Pty Ltd. All rights reserved.

Version: 18 Mar 2024